



Troubleshooting table NEXUS 7-speed

Problem SG-7C20/SG-7C21/SG-7R40/SG-7R41	Remedy
Noise while driving in 5th gear	<p>Check basic adjustment. Shift into 4th gear. Red markings (shifting unit) should be in a line.</p> <p>(No improvement)</p> <p>Increase / decrease cable tension during driving (adjust in 5th gear).</p> <p>(No improvement)</p> <p>Replace internal assembly</p>
Noises and slipping through the gears	<p>Check basic adjustment. Shift into 4th gear. Red markings (shifting unit) should be in a line.</p> <p>(No improvement)</p> <p>Increase / decrease cable tension during driving (adjust in 5th gear).</p> <p>(No improvement)</p> <p>If a "Revo Shifter" is installed, check that it moves smoothly. If the "Revo Shifter" is stiff, keep a distance between the twist grip / handlebar grip. The "Revo Shifter" should be mounted on the straight part of the handlebar.</p> <p>(No improvement)</p> <p>Spray oil into the control handle of the "Revo Shifter".</p> <p>(No improvement)</p> <p>Check parts of the shifting unit. Mixing the parts (CJ-7S40 / CJ-4S30) can cause shifting problems. Check shifting unit, assembly of inner cable fixing nut (distance from the end of outer housing). For CJ-7S40 it'd be 101mm.</p> <p>(No improvement)</p> <p>Replace internal unit.</p>
Sam wheels, equipped with SG-7C20 / SG-7C21 / SG-7R40 / SG-7R41, make different noises while driving.	<p>Different amounts of grease in the hub. Relubricate the hub. Please use the original NEXUS hub grease. Order number Y 04120210 (2.5 kg) or Y 04120300 (100 g).</p>
Click noises in 6th and 7th gear	<p>This is normal, due to the design (pawl E1).</p>
Noise while shifting from 5th to 6th gear. Sometimes the hub needs half a turn before the gear engages.	<p>This is normal, due to the design. Pawl A is pushed into position. This makes the switching process appear rougher</p>
Squeaking noises while driving in the 1st, 2nd, 3rd, 4th and 5th gear	<p>Axles of the planet gears in planet carrier 1 are dry. Please lubricate the axles with NEXUS grease. If the axles are already worn, replace planet carrier 1 (please pay attention to the synchronization of the planet gears). You can find information about this in the documents.</p>

SG-7C20  
SG-7C21  
SG-7S45

SHIMANO  
INTERO7



SG-7R40  
SG-7R41

Squeaking noises when driving in 3rd, 4th, 5th, 6th and 7th gear	Axles of the planet gears in planet carrier 2 are dry. Grease axles with NEXUS grease. If the axles are already worn, replace planet carrier 2 (make sure that the planet gears are aligned). Information about this in the manuals.
Hub stiff	<p>Check the position of the nuts. Open if necessary.</p> <p>(No improvement)</p> <p>Check hub housing for damage. Dust cap can be damaged. Check the seat of the seal (on the hub shell). Adjust if necessary.</p> <p>(No improvement)</p> <p>Check parallel alignment of brake arm SG-7C21 or BR-IM41 (SG-7R40 / SG-7R41).</p> <p>(No improvement)</p> <p>Replace internal assembly.</p>
Shifts from 1st to 3rd gear only.	<p>Broken feed cam (two small lugs broken off).</p>  <p>Replace whole unit or internal assembly. Experienced mechanics can replace the feed cam. The Shimano importer has spare parts for you.</p>
Hub does not switch in winter (at minus temperatures).	<p>Check shift inner cable and outer casing. Renew if necessary. We recommend Shimano SP40 or SP50 outer casing and rustproof Shimano 1.2 mm inner cables.</p> <p>(No improvement)</p> <p>Check shift lever "Revo" or "STI". There may be water (ice) in it. Grease. We recommend Shimano "No Sweat Slide".</p> <p>(no improvement)</p> <p>Remove the internal assembly. There may be water (ice) in the hub. Cause: cleaning with steam jet or hose with strong water jet. Renew the grease of the internal assembly. Please use NEXUS grease.</p> <p>(no improvement)</p> <p>Replace internal assembly.</p>
Gear indicator of the Revo shift lever SB-7S40 out of adjustment	Our Shimano importer has repair kits ready for you.
(SG-7C20 / SG-7C21) Rough braking and noise	Lubricate the brake sleeve and braking surface in the hub shell with NEXUS hub grease.
SB-7S45 does not change back to 1st and 2nd gear.	See next page for instructions.



## Repair manual Revo shifter SB-7S45

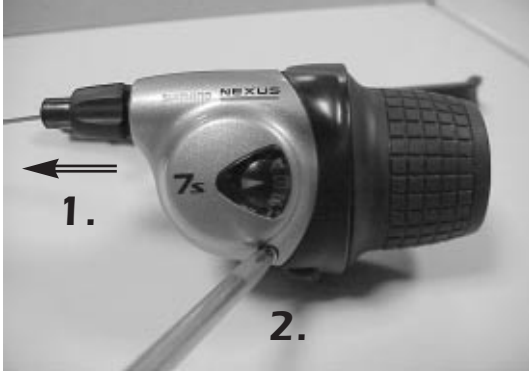

1. Unscrew (almost completely) the tension adjustment screw from the shifter (counterclockwise).
2. Remove the small screw from the OGD (optical gear indicator).



3. Remove the indicator (it only clicks into place).



4. Remove screw with Allen key (3 mm).



5. Now take the handle out of the housing. The gear with white teeth and handle forms one part.



6. It may happen that this small screw has loosened and blocked the shift lever. Screw the screw back in and secure with Loctite™.

7. Install the handle in the housing.
8. Tighten the screw with an Allen key (3 mm). Tightening force 15 ~ 20 kg / cm.
9. Snap the indicator back into place.
10. Screw the small screw into the OGD, turn the tension adjustment screw back to the original position (clockwise).

Please check the red markings on the switching unit.  
 The position of the Revo shift lever for adjustment = "4".